



TIMBERWOLF[®]

www.timberwolf-uk.com

TW125PH WOODCHIPPER



SAFETY INFORMATION AND BASIC OPERATING INSTRUCTIONS

Safety instructions

1. Before using this chipper, take time to read this safety and user's guide completely. **Misuse of this equipment can cause personal injury, equipment damage, damage to property and bodily injury.**
2. Familiarise yourself with the machine prior to use.
3. Do not attempt to start or use this machine if it is damaged. Contact the hire outlet before proceeding.
4. Do not allow minors, or anyone who is unwell or under the influence of drugs or alcohol to use this machine.
5. Petrol is highly flammable. Do not smoke when operating or refuelling.
6. This chipper is designed to chip solid wood material up to 125mm in diameter. Do not feed larger wood or other foreign material into the chipper.
7. Wear appropriate personal protective equipment (PPE). This includes face and eye protection and work gloves with snug cuffs. Noise levels above 85dB(A) will be experienced at the working position. Wear ear protection in compliance with EN352, with a SNR of 15dB or above. The use of a face mask is recommended if working conditions require. Do not wear loose clothing, jewellery or anything that could create a snag hazard.
8. Maintain a safety-exclusion zone around the chipper of at least 10 metres. Stop operations and turn off machine if unauthorised or unprotected individuals breach this zone.
9. Be aware that the chipper can eject chips out of the feed chute with considerable force. Always wear full head and face protection.
10. Only use this chipper in a well-ventilated area.

(Guaranteed Sound Power 121dB (A)).

Safe Transportation...

- ✓ Confirm a positive and locked connection between chipper and towing vehicle. Use the secondary coupling provided for.
- ✓ Observe maximum towing speeds. Reduce towing speed on rough or bumpy surfaces to maintain control, and to prevent damage to the machine.
- ✓ Ensure feed tray is securely latched closed.
- ✓ Verify discharge tube clamps are tight. Recheck often on long journeys.
- ✓ Check correct function of chassis lights.

Understanding the "No Stress" system...

The "No Stress" system controls the feed rate of the material going into the chipping chamber. Engine speeds will vary depending on the chipper's workload. If the engine speed falls below the predetermined level, the No Stress system stops the feed rollers until the engine speed rises, at which point the feed rollers will start turning without warning, and feeding will recommence.

Understanding the "Roller Control Box" functions...

The roller control box is located on top of the feed funnel. It controls the feed rollers that draw material into the chipping chamber. ***It does not control the main rotor.***

GREEN BUTTON - Forward (IN) feed - Push the button once - this starts the rollers and allows you to start chipping (as long as the engine speed is high enough - see 'No Stress').

RED BUTTON - Stop feed/emergency stop - This button stops the rollers from feeding. It overrides all other buttons or bars, and will not allow the other buttons to function until it has been reset. To reset, pull it out fully. The forward and reverse buttons will now function. The red stop button does **not** stop the engine or the rotor.

BLUE BUTTON - Reverse (OUT) feed - Push and hold - this allows you to back material out of the rollers while the button is pushed. You do not have to press the red stop bar or button before pressing the GREEN FEED button to recommence feeding. **NOTE:** It is important to check the correct function of the control box buttons before attempting to chip material. If any of the controls do not function as described above, DO NOT USE the chipper. Contact the hire centre.

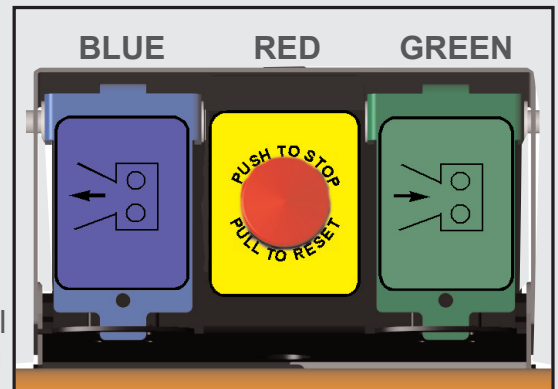

Understanding the "Safety STOP bar" function...

This is the large red bar that surrounds the sides and bottom of the feed funnel extension (tray). The bar is spring loaded and connected to a switch that interrupts the power to the feed rollers. The switch and bar are designed so that the switch is only activated if the bar is pushed to the limit of its travel. The bar does not need to be held there to stop the rollers. The feed rollers stop instantly, but can be made to turn again by pressing either the GREEN FEED or BLUE REVERSE control buttons. **NOTE:** It is important to check the correct function of the safety bar before attempting to chip material. If it does not function as described above, DO NOT USE the chipper. Contact the hire centre.

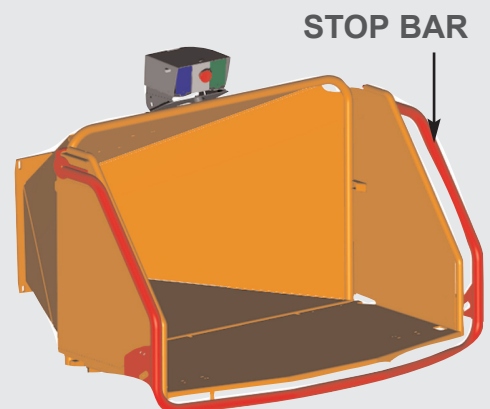

Before starting...

- Ensure that the exclusion zone is well marked. The use of hazard tape is highly recommended.
- Locate the machine on firm, level ground. Use prop stand if fitted.
- Make sure that all guards are in place.
- Check all fluids are within operating range. Contact hire outlet if servicing is required.
- Check the fuel level. Only clean, uncontaminated, diesel fuel must be used.
- Check the infeed chute and clear it of any objects.
- Adjust the discharge deflector to a safe direction.
- Wear appropriate safety gear (PPE).
- Clear the working area of unauthorised/unprotected personnel.

Starting the engine...

FOR A COLD ENGINE

1. Place throttle lever at 1/3rd open and pull choke out to "on".
2. Insert key, turn to "start" and release to "on" once engine starts.
3. Gradually return choke to the "off" position as engine warms up.
4. Allow engine to run at least 1 minute before starting to chip.

If the engine fails to start after 10 seconds of cranking, leave for 1 minute and try again.

FOR A WARM ENGINE

Follow the instructions for a "cold engine" but return the choke to the "off" position as soon as the engine starts.

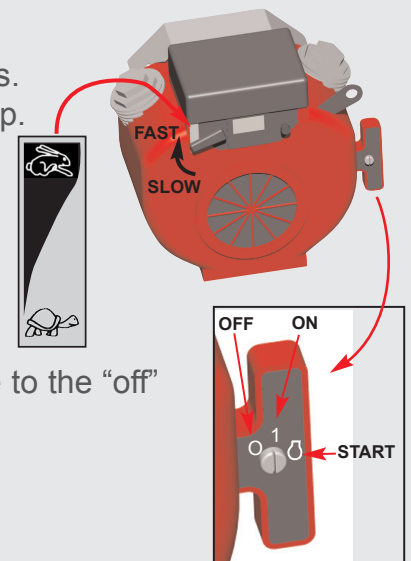

Stopping the engine...

1. Reduce the throttle to idle.
2. Leave the engine to run for 1 full minute.
3. Switch the key to the "OFF" position.
4. Remove ignition key.

Chipping wood...

- Maximum diameter wood to be chipped in the TW 125PH is 125mm.
- Increase throttle to full. Never attempt to chip without throttle in full.
- **BE AWARE...** awkward shaped wood being chipped can thrash from side to side in the funnel with great force. Stand clear of wood extending from the funnel.
- Load wood from either side of funnel opening avoiding the middle as much as possible.
- Load wood butt end first.
- Trim badly twisted brush before attempting to feed it into the chipper.
- **NEVER REACH IN TO** the funnel while the chipper is running, use a push stick suitable for the job.
- Always observe the discharge for exiting wood chippings. REMEMBER... what goes in must come out. If there are no chippings exiting the discharge while chipping wood, a blockage has occurred. You must stop the chipping operation, turn off the machine and clear the blockage. (see "Clearing blockages" section on next page.)



TIMBERWOLF[®]

www.timberwolf-uk.com

Clearing Blockages...

1. Stop the engine and remove ignition key. Wait for engine to run down.
2. Remove discharge tube by unscrewing clamp with fitted handle only. Check and clear if necessary.
3. Wearing gloves, reach into the rotor housing and scoop out the majority of any debris causing the blockage. **WARNING...** never reach into the rotor housing with unprotected hands. There are sharp blades inside, and any small movement of the rotor can cause serious injury.
4. Replace discharge tube.
5. Restart engine and increase to full throttle.
6. Allow sufficient time for machine to clear excess chips before commencing work.

Never attempt to carry on chipping once a blockage is identified. Carrying on chipping in this instance will compact chips in the rotor housing and will become very difficult to clear.

- The machine must be returned in a clean condition. Cleaning is chargeable at the hire outlet.
- Any damage to the machine is chargeable.



Dealer Stamp